

CTI-E Dual Seals

Agitator Seals - Liquid Lubricated



Product Description

1. Dual seal configuration
2. Balanced design
3. Independent of direction of rotation
4. Cartridge construction
5. Designed for top entry vessels
6. Rotary unit with multiple springs
7. Integrated bearing construction available on request

Technical Features

1. Over all connecting dimensions are tailor made to customer's specifications
2. Specially designed to handle high operating pressure
3. The seal design is unique as it closes due to the hydraulic product pressure as well overlaying barrier pressure
4. Rugged design to ensure long term reliability and operating life
5. Seals are assembled in cartridge construction for easy fitment

Typical Industrial Applications

Chemical industry	Dryers
Pharmaceutical industry	Mixers
Suitable for all media	Filter
Agitators	Special rotating equipment

Product variants

Double seal variants
 BSH(V)-D
 Double seal BSH(V)L-D
 Double seal with integrated floating bearing (axial thrust bearing on request).

Performance Capabilities

Shaft diameter: $d_w = 20 \dots 400 \text{ mm}$ (0.79" ... 15.75")
 Pressure: $p_1 = \text{vacuum} \dots 250 \text{ bar}$ (... 3,625 PSI)*,
 $p_3 = p_1 + 10 \%$
 Temperature: $t = -40 \text{ }^\circ\text{C} \dots +200$ (350) $^\circ\text{C}$
 (-40 $^\circ\text{F}$... +392 (662) $^\circ\text{F}$)
 Sliding velocity: $v_g = 0 \dots 5 \text{ m/s}$ (0 ... 16 ft/s)
 For application beyond this range, please enquire.

Notes

Options:
 Cooling or heating flange
 Leakage drain, flush or heating flange
 Leakage drain or flush
 Polymerization barrier, leakage drain or flush

Standards

FDA

Materials

According to application and customer's specification

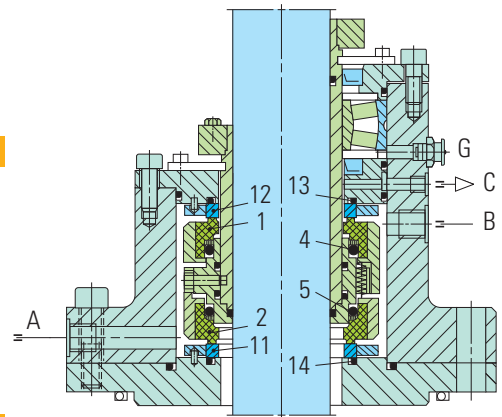

Torque Transmissions

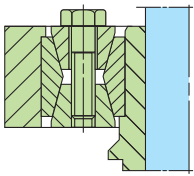

Clamping set

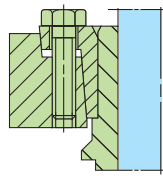

Shrink disk

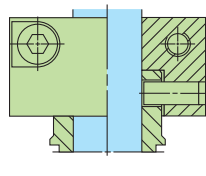

Clamping ring with pin

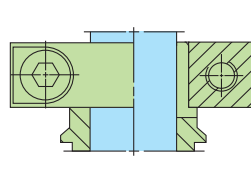

Clamping ring

Item	Description
1	Seal face, atmosphere side
2	Seal face, product side
4, 5, 13, 14	O-ring
11	Seat, product side
12	Seat, atmosphere side

Installation, Details, Options

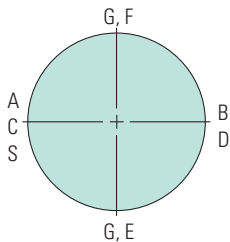

Supply connections

- A Barrier fluid IN
- B Barrier fluid OUT
- C Drainage
- D Leakage drain G1/8"
- E Cooling IN G3/8"
- F Cooling OUT G3/8"
- G Grease
- S Flush

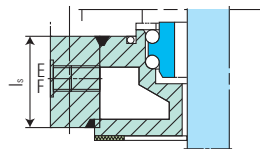

Option

Cooling flange, can be used alternatively as a heating flange ($t_{max.} = 350^\circ\text{C}$ (662 $^\circ\text{F}$)).

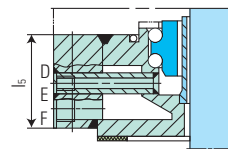

Option

Leakage drain, can be used alternatively as a flush or as a heating flange.

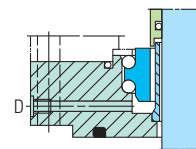

Option

Leakage drain, can be used alternatively as a flush.

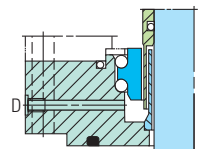

Option

Polymerization barrier, can be used alternatively as a leakage drain or a flush.